

MASSACHUSETTS HISTORICAL COMMISSION  
 294 Washington Street, Boston, MA 02108



Somerset, Mass.

Behind

3671 County St. (Route 138)

Buffington

Ship:

Public

Private

NOTATION:

Approximate number stones 12

Earliest death date None discernible

Latest death date None discernible

Condition The 40' x 50' cemetery has only jagged bits of slate protruding an inch or so above ground. Debris i.e. cans, garden cuttings and weeds abound. At the time of the picture taking a beef cattle was contained within its walls. Rock walls tumbled in spots.

SKETCH MAP

Draw map showing property's location in relationship to nearest cross streets and other buildings or geographical features. Indicate north.

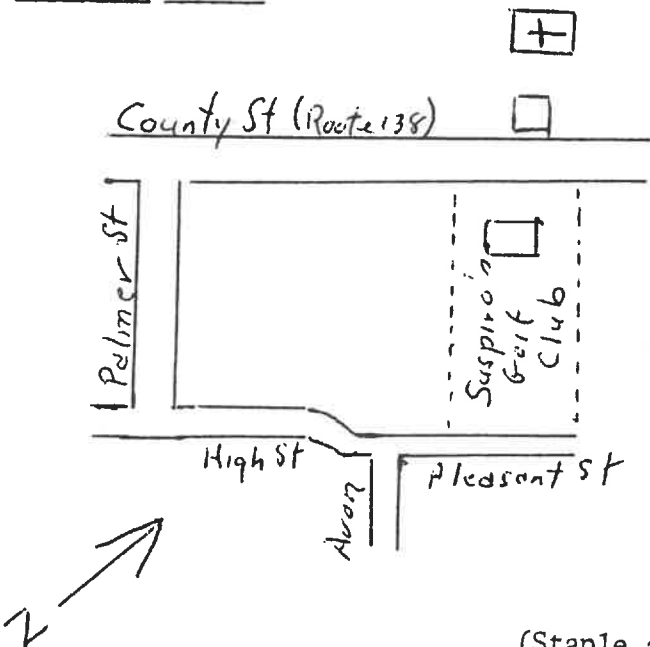

Recorded by James Bradbury

Organization Somerset, Historical Commission

Date 13 May 1983

ASSESSMENT OF ART WORK (describe materials used, designs, motifs, symbols that are either common or unusual, known carvers).

Only indication of a cemetery are the bits of jagged slate tops barely visible above ground.

HISTORICAL SIGNIFICANCE (discuss religious affiliations, major period of use, importance within town).

#7

## Slade (Slade-Wilbur) Cemetery

**Location:** Slade Cemetery, (Slade-Wilbur Cemetery), South of Whetstone Hill Rd on the Souza Farm, between two housing subdivisions, and behind the homes on Red Fox Trail. Area 50x80', and bounded by fieldstone walls. Entry from north side through an iron gate mounted between two 4.5' granite pillars is blocked off by arbor vitae on the property of the north side abutter. Access is thru an easement between two properties at the top of Red Fox Trail at a utility pole.

**Condition:** Thickly overgrown with brush, poison ivy, and trees. Gray slate headstones, ground covered with myrtle in bloom in 1975. Earliest discernible date was 1810. Plot is on a knoll from which a panoramic view of the Taunton River is obtainable. A small 12" diameter round white marble stone lying in brush bore the inscription "Lizzie and Jaime" evident in 1975, not found in 2015. One headstone, James W. Chace, died 1863, stated "He was patient in his sickness, calm in his death, willing to submit to the will of God", but not found in 2015. Five white marble headstones found toppled in the ground cover and one small white marble stone appearing to be for a baby with not inscription was found against a tree. MACRIS SOM.825, oldest documented marker 1810. Requires clean up and further evaluation.





Phebe, wife of Jeremiah Chace, died February 3<sup>rd</sup>, 1889, in her 82<sup>nd</sup> year





117

# Cemetery Reconnaissance Inspection Checklist



Chicora Foundation, Inc.  
PO Box 8664  
Columbia, SC 29202  
803-787-6910

Name of Cemetery: *Wade-Welber*

Location: *North of Red Fox Trail (Souza Farm)* State: *MA*

Site No.: *Between Whitestone and Red Fox Trail top of hill*

UTM Coordinates: Datum: Zone: E: N:

Date: *5/2015*

Photographs: *Rich Shere / Diane Goodwin*

Maintenance Item	Standard	Sat	Unsat	Remarks	
1. Grounds	Grass is cut, no rubbish or debris on the ground. Good landscaping	<input type="checkbox"/>	<input checked="" type="checkbox"/>	<i>Creeper Myrtle, Virginia Creeper</i>	
2. Roads	Paved with no potholes and no flooding	<input type="checkbox"/>	<input type="checkbox"/>	<i>Ease next between yards</i>	
3. Burial Sites	No sinking burial sites. Old flowers and other items disposed of properly	<input type="checkbox"/>	<input type="checkbox"/>	<i>road to ease next good unknown</i>	
4. Monuments	Intact, not broken or in need of repair/replacement. In proper position.	<input type="checkbox"/>	<input type="checkbox"/>	<i>All toppled, none standing</i>	
5. Plaques or Other Features	Clean and maintained with no broken items	<input type="checkbox"/>	<input type="checkbox"/>	<i>All broken, one base</i>	
6. Structures or Buildings	Clean and maintained, good general housekeeping. No structural deficiencies. Roof and gutter good condition.	<input type="checkbox"/>	<input type="checkbox"/>	<i>5 headstones observed none</i>	
7. Safety	No hazardous conditions such as uneven sidewalks or fire conditions. No monument threats.	<input type="checkbox"/>	<input type="checkbox"/>	<i>Axonal holes, poison 10/1</i>	
8. Drainage	Proper maintenance of culverts, downspouts, grates and good site drainage.	<input type="checkbox"/>	<input type="checkbox"/>	<i>Good</i>	
9. Utilities	Has water and electricity.	<input type="checkbox"/>	<input type="checkbox"/>	<i>none</i>	
10. ADA	Meets ADA requirements for bathrooms, parking, access routes.	<input type="checkbox"/>	<input type="checkbox"/>	<i>no</i>	
11. Other	General observations regarding monuments.	<input type="checkbox"/>	<input type="checkbox"/>	<i>needs restoration</i>	
12. Overall Condition of Site	Standard: Excellent site had no discrepancies. It was clean and well maintained with the monuments in overall good condition. Good site has minor discrepancies, however, it was clean and well maintained. Fair site required repairs and/or maintenance. Abandoned site requires extensive preservation efforts.	<input type="checkbox"/>	<input type="checkbox"/>	<input type="checkbox"/>	<input checked="" type="checkbox"/> <i>Remarks: Abandoned site, neglected for many years, priority - 5 marble stones toppled, but visible</i>

Priorities: *Very high priority, but not during poison 10/1 season.*